

## PRINTABLE INFO SHEET

Series: Manorwood Ranch & Cape Homes  
Model: 2M3015-R Wiltshire



### About This Model

Style: Ranch / Bedrooms: 3 / Bathrooms: 2 / Square Feet: 1878

## CUSTOMER CONTACT

Notes:

---

---

---

---

# PRINTABLE INFO SHEET

Series: Manorwood Ranch & Cape Homes  
 Model: 2M3015-R Wiltshire



## Floorplan

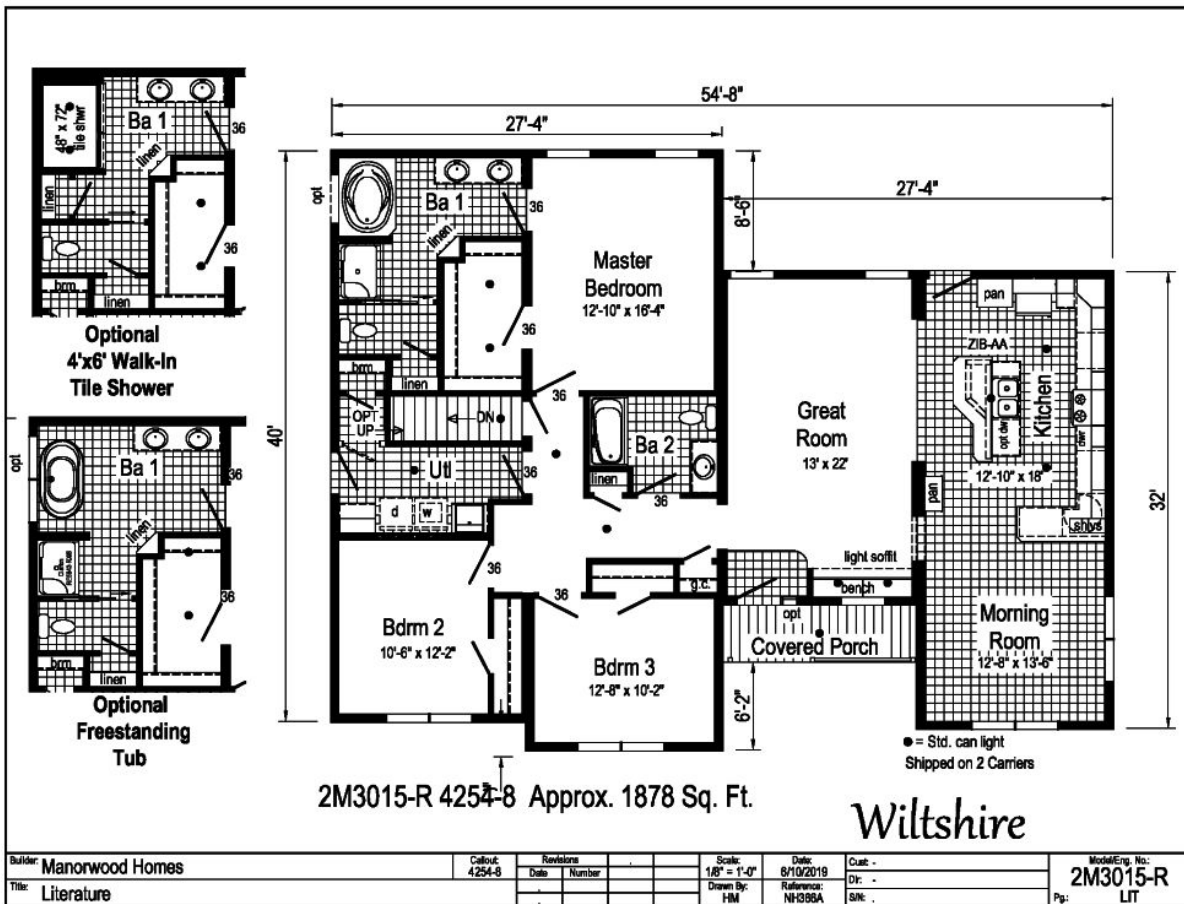

## CUSTOMER CONTACT

Notes: \_\_\_\_\_

\_\_\_\_\_

\_\_\_\_\_

\_\_\_\_\_

## PRINTABLE INFO SHEET

**Series: Manorwood Ranch & Cape Homes**

**Model: 2M3015-R Wiltshire**



## Standards & Features

### FLOOR CONSTRUCTION

2X10 Floor Joists 16" O.C.  
3/4" T&G OSB Floor Decking  
Insulated Basement Stairwell

### EXTERIOR WALLS

2X6 Studs 16" O.C.  
Double 2X6 Top Plates  
8' Wall Height  
Structural OSB Sheathing  
Whole House Wind Wrap  
Vinyl Siding

### INTERIOR WALLS

2X4 Interior Wall Studs 24" O.C.  
2X4 Marriage Wall Studs 16" O.C. with  
OSB Sheathing  
Primed 1/2" Smooth Drywall Throughout

### ROOF AND CEILING

8' Flat Ceiling  
5/12 Roof Pitch with 12" Eaves  
7/12 Roof Pitch with 12" Eave (certain models)  
Pre-Engineered 40# Roof Trusses 24" O.C.  
90 MPH Wind Exposure C Wind Load Design  
Ice Shield  
Structural OSB Roof Decking  
Shingle Over Ridge Vent Ventilation  
Vented Vinyl Soffit  
Aluminum Fascia  
Aluminum Drip Edge on all Roof Edges  
Smooth Drywall Ceiling  
Architectural Shingles  
(Limited Lifetime Warranty)

### ROOF AND CEILING (continued)

Synthetic Roof Underlayment

### INSULATION

Exterior Walls R-21 Fiberglass Insulation  
Ceiling R-38 Fiberglass Batt Insulation

### PLUMBING

PEX Water Lines Stubbed Through Floor  
Drain, Water and Vents Stubbed Through Floor  
Shut Off Valves for all Sinks, Lavs and Toilets  
Plumb, Wire and Vent for Washer/Dryer  
Oetiker Clamps

### EXTERIOR DOORS AND WINDOWS

3/0 x 6/8 6-Panel Fiberglass Door with Nickel  
Hardware & Composite Jambs at Front & Rear  
Primed White  
Door Pan on Exterior Doors  
Low-E Vinyl Insulated Single Hung Argon Filled  
White Windows & Mulled where Applicable  
Front & Rear Door Kwikset Lockset with Smart Key  
15" Raised Panel Shutters Door Side

### INTERIOR DOORS AND TRIM

2-Panel Painted White Interior Doors w/  
Lever Passage Sets and 3 Mortise Hinges  
36" Interior Doors & Where Available  
Privacy Locks on Bedroom & Bath Doors  
Door Stops  
White Wood Colonial Moulding Package  
Wire Shelving all Closets and Washer / Dryer Area  
Brushed Nickel Hardware

### FLOOR COVERING

Congoleum Vinyl Flooring

## CUSTOMER CONTACT

Notes:

---

---

---

---

## PRINTABLE INFO SHEET

**Series: Manorwood Ranch & Cape Homes**

**Model: 2M3015-R Wiltshire**



## Standards & Features (continued)

### FLOOR COVERING (continued)

(Kitchen, Baths, Utility and Foyer)  
25 oz. Carpet with Stain Protector  
5# Rebond Carpet Pad

### KITCHEN

3/4 Overlay Classic Craft Cabinetry  
- KCMA Certified  
Hardwood 5-Piece French Country Oak or Barnwood Oak  
Mission Flat Panel Doors  
Craftsman Cabinet Crown Moulding  
42" Height Kitchen Overhead Cabinets  
Dovetailed Drawers  
100# Undermount Drawer Guides  
Laminate Countertops  
8" Deep Stainless Steel Kitchen Sink  
Brushed Nickel Metal Faucet with Sprayer  
Power Range Hood  
Transitional Cabinet Pulls (Brushed Nickel or Black)  
Corner Base Lazy Susan (where applicable)  
USB Receptacle  
Soft Close Drawers

### BATHS

Brushed Nickel Metal Faucets  
Anti-Scald Valves for Showers & Tubs  
Laminate Countertops  
China Lavs  
Elongated Toilets  
Lighted Exhaust Fans with Insulated Ducts  
2-Arm Light and Framed Mirror at Vanity  
60" One Piece Fiberglass Tub/Shower  
Fiberglass Soaker Tub (per plan)

### BATHS (continued)

48" One Piece Fiberglass Shower with Glass  
Shower Enclosure (per plan)  
Double Bowl Bath Vanity (per plan)  
Framed Mirrors  
Linens with Drawers (where available)

### ELECTRICAL

200 AMP Electrical Service with 40/40 Panel Box  
2 GFI Exterior Receptacles with In-Use Covers  
Craftsman Light at Front Exterior Door  
Patina Lantern Light at Rear Exterior Door  
Recessed LED Lighting T/O  
(Excludes Bedroom Ceiling Lights)  
Smoke Detectors with Battery Back-up  
Wire for Electric Range  
Carbon Monoxide Detector(s)  
Electric Doorbell at Front Door

### CAPE MODELS

12/12 Roof Pitch with 12" Eaves  
12/12 and 7/12 Combination Roof Pitch  
with 12" Eaves  
Close-Off Package for 2nd Floor Including  
Interior Door and Partitions for On-Site Install  
3/4" OSB Floor Decking for 2nd Floor & \*Shipped Loose\*  
(2)&110' Electrical Circuits to Junction Boxes  
for Future Lights & Electrical Circuit to  
Junction Box for Future Smoke Detector(s)  
Electrical Circuit to Junction Box for  
Future 3-Way Light on 2nd Floor  
Rough-In Plumbing for Future Bath

## CUSTOMER CONTACT

Notes:

---

---

---

---

## **PRINTABLE INFO SHEET**

**Series: Manorwood Ranch & Cape  
Homes**

**Model: 2M3015-R Wiltshire**



## **Standards & Features (continued)**

### **CAPE MODELS (continued)**

Stairs with Railing, Handrail and Carpet

Shipped Loose

(2nd Floor Gable End Windows Optional)

10 YEAR RESIDENTIAL WARRANTY

## **CUSTOMER CONTACT**

Notes:

---

---

---

---